

SYSTEM STATISTICS:

Dry Material Capacity	125	Tons/Day
Wet Material Capacity	1400	Tons/Day
Gradient	.5% - 2%	(unless noted)
Level 1:	73,000	cubic feet
	2,500	paving bricks
Level 2:	407,000	cubic feet
	14,500	paving bricks
Level 3:	520,000	cubic feet
	18,750	paving bricks
Total, Levels 1, 2, & 3	1,000,000	cubic feet
	35,750	paving bricks

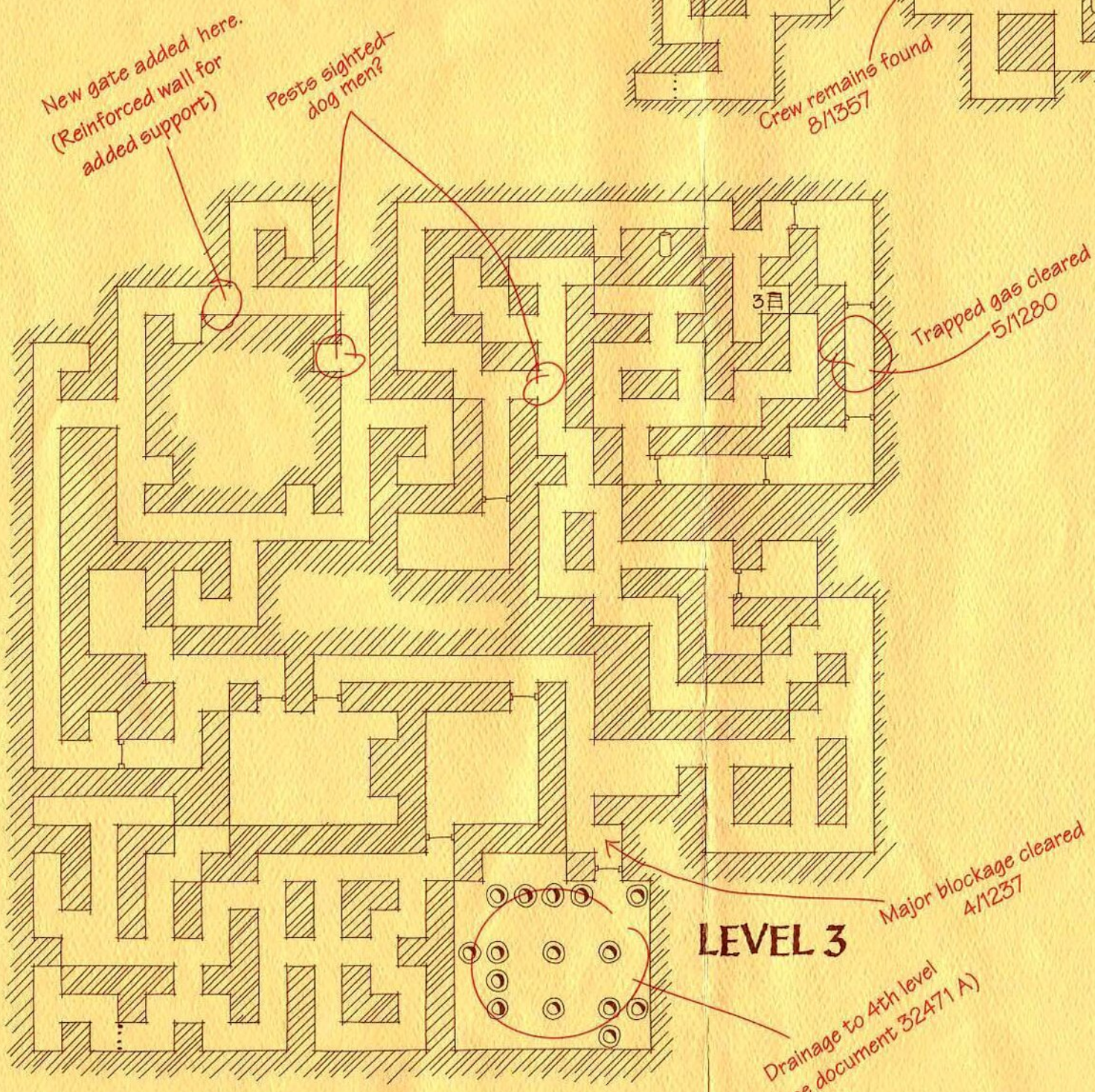

KEY

— —	Gates	▒	Grate
— ... —	Bar Gates	≡	Ladder
○	Drains	▨	Stone
□	Pipes		

**CITY OF WATERDEEP**  
Civil Engineering Department  
Sewer System Map  
Levels 1, 2 and 3  
Document no. 32471  
Date: 23/10/1162